

**SPECIFICATIONS**

|                                  |  |
|----------------------------------|--|
| <b>IP100H</b>                    |  |
| Wireless standards               | IEEE 802.11 a/b/g/n  |
| Frequency range                  | 2.4-2.4835 GHz, 5.15-5.35, 5.47-5.85 GHz   |
| Dimensions (W x H x D)           | 58 x 95 x 26.4 mm<br>2.3 x 3.7 x 1.0 in (with BP-271)  |
| Weight (approx.)                 | 205 g, 7.2 oz (with BP-271 and antenna)  |
| Operating time*                  | More than 20 hours (with BP-271)   |
| RF output power                  | Less than 10 mW/MHz  |
| Voice Codec                      | G.711 µ-law (64 kbps)  |
| AF output power (10% distortion) | Internal SP 400 mW (typ., 16 Ω load)<br>External SP 200 mW (typ., 8 Ω load)  |
| Security                         | WEP (64/128-bit), WPA-PSK (TKIP/AES), WPA2-PSK (TKIP/AES)  |
| Operating temperature            | -10 °C to +60 °C; +14 °F to +140 °F<br><small>*Projections are not included. **Tx: 100% duty cycle. *1: 1: 0 duty cycle.</small> |

- Supplied accessories**
- BP-271 Li-ion battery pack
  - MB-127 belt clip
  - Hand strap
  - Antenna cap

**IP100FS (System requirements)**

|                    |  |
|--------------------|--|
| Operating system   | Windows® 10 (32-bit/64-bit)<br>Windows® 8 (32-bit/64-bit)<br>Windows® 7 (32-bit/64-bit) SP1 or later, (except for Windows® RT) |
| CPU                | Intel® Core™ 2 Duo Processor E6600/ 2.4 GHz or better  |
| Memory             | 2 GB or higher   |
| Hard disk space    | 1 GB of disk space (for saving log files)  |
| Audio              | DirectSound compatible audio (Frequency response up to 20 kHz, sampling rate 48 kHz)   |
| Display resolution | 1920x1080 pixel recommended<br>1024x768 pixel minimum  |
| Other              | USB 2.0 port,<br>10 Mbps or faster Ethernet interface, speaker, microphone or headset  |

**IP1000C**

|                        |  |
|------------------------|--|
| Power supply           | 100-240 V AC (With supplied AC adapter)                                    |
| Operating temperature  | 0 °C to +40 °C; +32 °F to +104 °F  |
| Dimensions (W x H x D) | 232 x 38 x 168 mm; 9.1 x 1.5 x 6.6 in                                      |
| Weight (approx.)       | 750 g, 1.65 lb (Main unit only)  |
| LAN                    | RJ-45 connector x 4<br>1000BASE-T/100BASE-TX/10BASE-T (Auto MDI/MDI-X)     |
| USB                    | Standard A receptacles x 2   |
| Maintenance console    | RS-232C (RJ-11) connector<br><small>*Projections are not included.</small> |

- Supplied accessories**
- BC-207S AC adapter
  - Cushion sheets
  - Ferrite core

**AP-95M**

|                        |   |
|------------------------|---|
| Power supply           | 12 V DC ±10% or PoE (IEEE802.3af compatible)  |
| Dimensions (W x H x D) | 162 x 162 x 42 mm; 6.4 x 6.4 x 1.7 in   |
| Weight (approx.)       | 520 g, 1.1 lb (Accessories not included)  |
| Cable LAN              | RJ-45 connector x 1<br>1000BASE-T/100BASE-TX/10BASE-T (MDI/MDI-X automatic distinction) |
| Wireless LAN           | IEEE 802.11 a/b/g/n/ac  |
| Frequency range        | 2.412-2.472 GHz, 5.18-5.24, 5.472-5.825 GHz   |
| Security               | WEP (64/128/152-bit), WPA, WPA2, WPA-PSK, WPA2-PSK, IEEE 802.1X/EAP                     |
| Operating temperature  | -10 °C to +55 °C; +14 °F to +131 °F<br><small>*Projections are not included.</small>    |

- Supplied accessories**
- AC adapter\*
  - Mounting bracket
- \*Depending on the version.

All stated specifications are subject to change without notice or obligation.

**OPTIONS**

**For IP100H**

|  |   |  |
|--|---|--|
| <p><b>BP-271</b><br/>Rechargeable Li-ion 1100/1200 mAh (min. typ.)</p> <p><b>BP-272</b><br/>Rechargeable Li-ion 1680/2000 mAh (min. typ.)</p> <p><b>BP-273</b><br/>Li-ion 2x4V batteries x 3</p> | <p><b>Rapid charger</b></p> <p><b>BC-202/P2</b>   <b>BC-1235*</b></p> <p><small>BC-1235A for USA plug, SE for Europe plug, SE for Australia plug.</small></p> | <p><b>Multi-charger</b></p> <p><b>BC-157S</b></p> <p><b>BC-211</b></p> |
|--|---|--|

|   |  |   |
|---|--|---|
| <p><b>Headset (Full-duplex operation)</b></p> <p><b>HS-102</b> Earphone type<br/><small>OPC-2359 is required.</small></p> <p><b>OPC-2359</b> PTT switch cable</p> | <p><b>Earphone-microphones (Full-duplex operation)</b></p> <p><b>HM-163LS</b>   <b>HM-166LS</b></p> <p><small>Use HM-163LS or HM-166LS for full-duplex operation also.</small></p> | <p><b>Speaker-microphones (Simplex operation)</b></p> <p><b>HM-183LS</b> IPX7 Waterproof</p> <p><b>HM-186LS</b></p> |
|---|--|---|

|  |  |
|--|--|
| <p><b>Headsets (Simplex operation)</b></p> <p><b>HS-94*</b> Earhook type</p> <p><b>HS-95*</b> Behind-the-head type</p> <p><b>HS-97*</b> Throat type</p> <p><small>*Either OPC-2006LS or OPC-2328 is required when using any of these headsets.</small></p> | <ul style="list-style-type: none"> <li>• <b>MB-127:</b> Belt Clip. Same as supplied.</li> <li>• <b>OPC-2006LS:</b> Plug adapter cable.</li> <li>• <b>OPC-2328:</b> PTT switch cable.</li> </ul> <p><small>Either OPC-2006LS or OPC-2328 is required when using any of HS-94, HS-95 or HS-97.</small></p> <ul style="list-style-type: none"> <li>• <b>OPC-478UC + OPC-2144:</b> Setup cables</li> </ul> <p><small>Both cables are required for initial setup.</small></p> |
|--|--|

**For IP100FS**

|  |   |  |  |   |
|--|---|--|--|---|
| <p><b>PTT microphone adapter</b></p> <p><b>CT-23</b></p> | <p><b>AC adapter</b></p> <p><b>BC-147S*</b><br/><small>For use with CT-23</small></p> | <p><b>Desktop microphone</b></p> <p><b>SM-25</b></p> | <p><b>Hand microphone</b></p> <p><b>HM-152</b></p> | <p><b>Serial cable</b></p> <p><b>OPC-1402</b></p> |
|--|---|--|--|---|

\*BC-147SA for USA plug, SE for Europe plug, SE for Australia plug.

**For AP-95M**

**Access point management software**

**RS-AP3**  
Configure and monitor individual/all access points in a network for centralized management.

IP ADVANCED RADIO SYSTEM

# Full-Duplex Communication That Works Over a Wireless LAN and IP Network\*

- Easy system to set up and use
- Up to 100 users can communicate at the same time
- Encryption provides extra security
- Range is only restricted by your IP network coverage
- No licence fee required, no call charges

ICOM, Icom Inc. and Icom logo are registered trademarks of Icom Incorporated (Japan) in Japan, the United States, the United Kingdom, Germany, France, Spain, Russia, Australia, New Zealand and/or other countries. IDAS and IDAS logo are trademarks of Icom Incorporated. NXDN is a trademark of Icom Incorporated and JVC KENWOOD Corporation. dPMR is a trademark of the dPMR MoU Association. Windows and Windows Vista are other registered trademarks or trademarks of Microsoft Corporation in the United States and/or other countries. All other trademarks are the properties of their respective holders.

\*Requires either HM-153LS, HM-166LS or HS-102 with OPC-2359 for full-duplex operation.

# Wireless LAN System Extends Your Communication Coverage.

## Individual, Group or Area Communication



Staff spread across an extended site, such as a hotel, can communicate seamlessly.

## Hands-free, Full-duplex Communication



With an optional earphone-mic or headset HS-102, the IP100H user can talk and receive simultaneously like a phone call. Hands-free operation allows your staff to carry out other tasks at the same time.

## Intra-building Communication

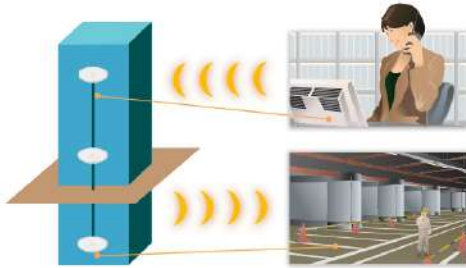

By deploying access points along the IP network, the IP advanced radio system can communicate all the way from the basement to the top floor. The IP100H can access the nearest access point and can roam between access points\*. \*Some SSIDs are required for roaming use.

## Dispersed Sites Communication



If connected over an Internet VPN, the IP100H/IP100FS can communicate between dispersed sites such as offices or shops in different cities.

## Full-duplex Communication

With an optional earphone-mic or headset HS-102, the IP100H can talk and receive at the same time. All users in the system can communicate simultaneously.

## High Security

The wireless LAN security protocols (WPA-PSK (TKIP/AES), WPA2-PSK (TKIP/AES)) encrypt your private conversations.

## Status and Short Data Messaging

The IP100H/IP100FS can send status and short data messages\* to other users.

\* The IP100H can send only preprogrammed messages.

## Easy System to Set Up and Use

The IP1000C programs almost all terminal configurations over the air. Individual PC programming via cable connection is not required. (Except initial setup)

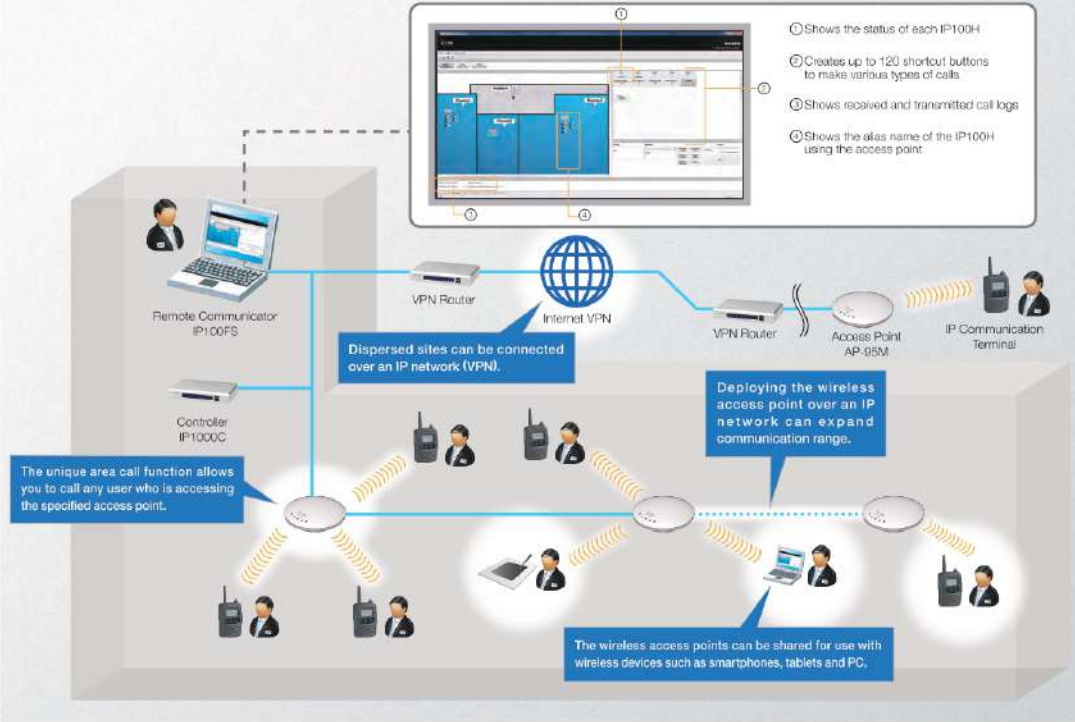

## Application examples

- Hotels
- Warehouse / Manufacturing
- Hospitals
- Security
- Restaurant / Drive Thru
- Supermarkets / Retail Shops

## IP Communication Terminal IP100H

- IPX7 waterproof (1m depth water for 30 minutes) for outdoor work or places prone to get wet.
- Compact 58x95x26.4 mm body and 205g (approximate) lightweight.
- Vibration alert function for incoming calls.
- Emergency call with higher priority.
- Tested to the MIL-STD 810 G specifications.



\*The IP100H can be used with an internal antenna. (Communication range will decrease to half from/to access points.)

## Wireless LAN Access Point AP-95M

- IEEE 802.11 a/b/g/n/ac compliant
- PoE (Power over Ethernet) capability
- Optional RS-AP3, Access point management software



## Remote Communicator IP100FS

(Supplied with USB flash drive for use as a USB hardware key)

- The IP100FS can communicate with IP communication terminals from a PC.
- The IP100FS can obtain location information of each IP100H based on the access point being used.
- Can be installed on a Windows® based tablet PC as well as a laptop PC.



## Controller IP1000C

- The IP1000C controls all terminal configurations and voice traffic.
- Capable of controlling up to 100 terminals (including IP100FSs).
- Links up to 11 IP1000Cs over an IP network (Internet VPN) and increases the number of usable IP100H/IP100FS communication terminals to 1100 units.



## RoIP GATEWAY

### IP Phone and Transceiver Interconnection

With a VE-PG4 RoIP gateway, the IP advanced radio system can interconnect with an IP phone, LTE, iDAS™ Conventional, Type-D multi-site trunking and analogue transceivers. The VE-PG4 has a built-in controller function (equivalent to the IP1000C function), capable of controlling up to 50 IP communication terminals.



RoIP Gateway VE-PG4

### Interconnection image

The IP communication terminals, radios and telephones can communicate with each other within the doughnut shaped blue ring.

